

USER MANUAL

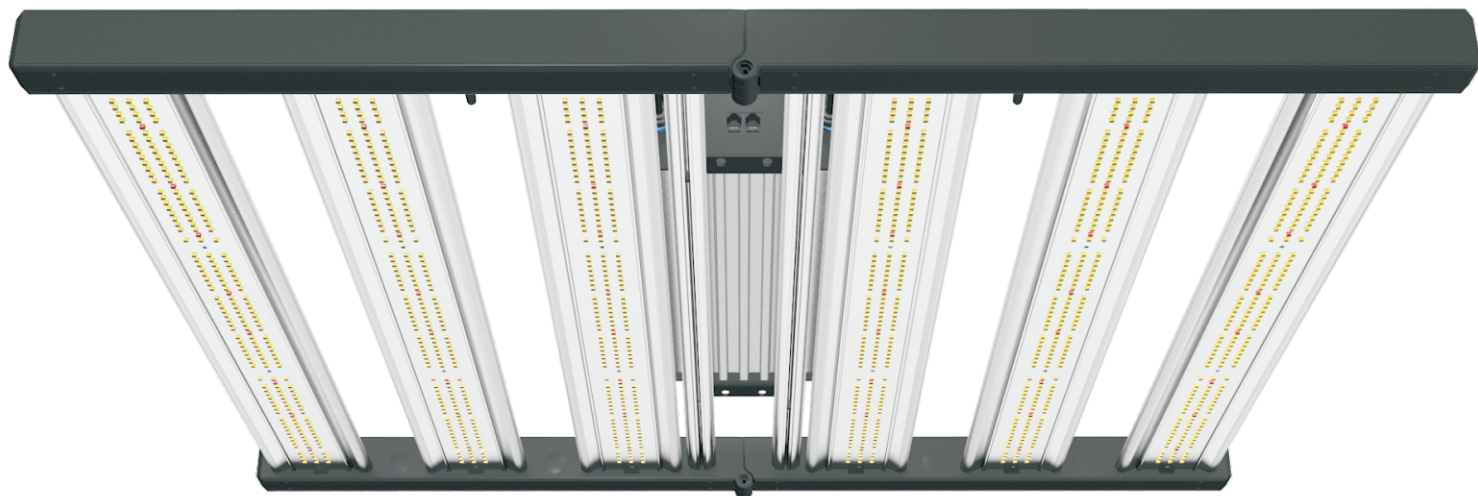

FC CE RoHS

Accessories Contents

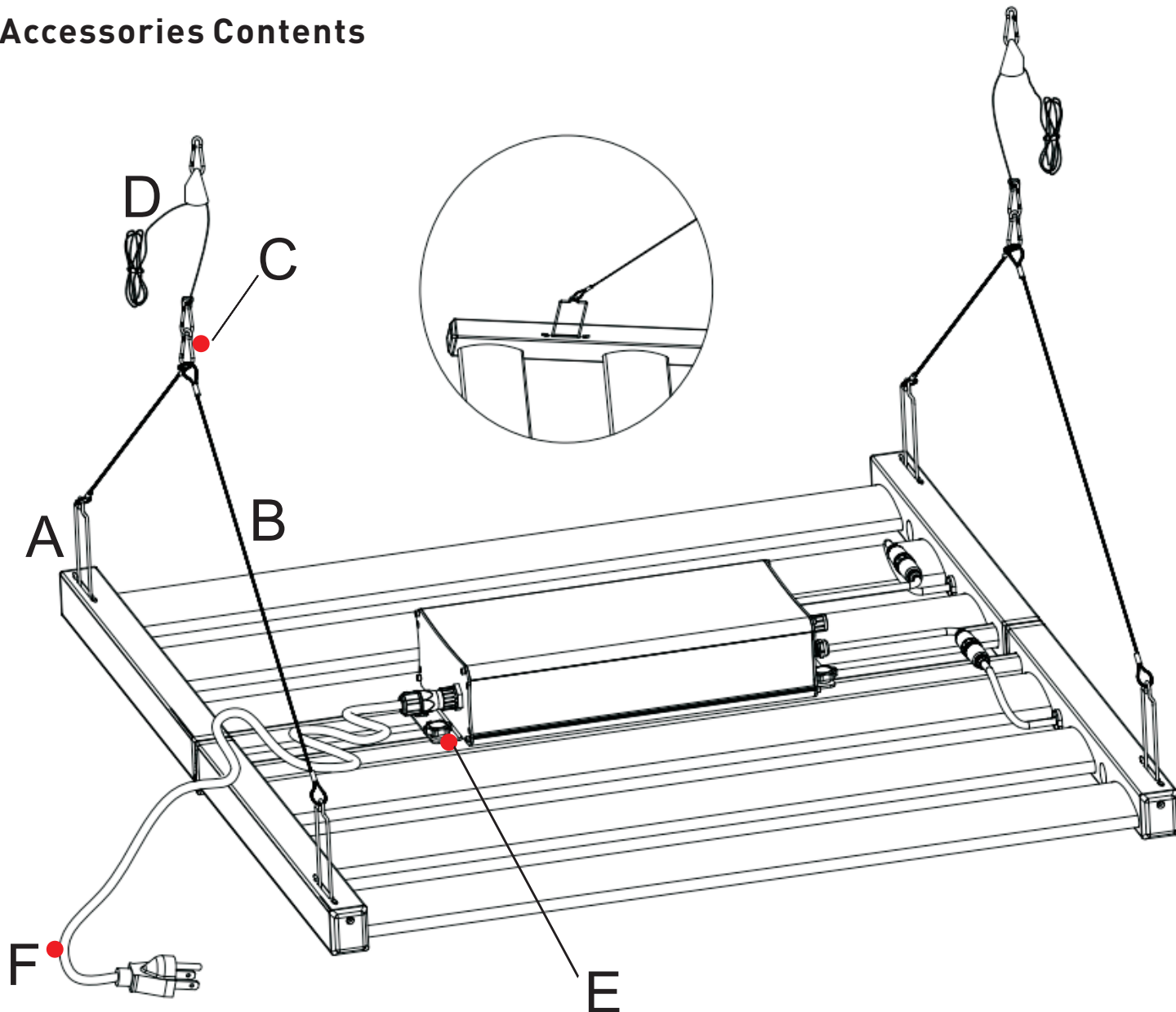

A: Mounting Clips (4 pcs)

B: 17.7" (45cm) Stainless Steel Ropes (4 pcs)

C: Mounting Hooks (2 pcs)

D: Adjustable Ratchet Hangers (2 pcs)

E: Konb screws for Fixing LED Driver Box (4 pcs)

F: AC Power Cord and Plug (1 pc)

Dimension & Weight

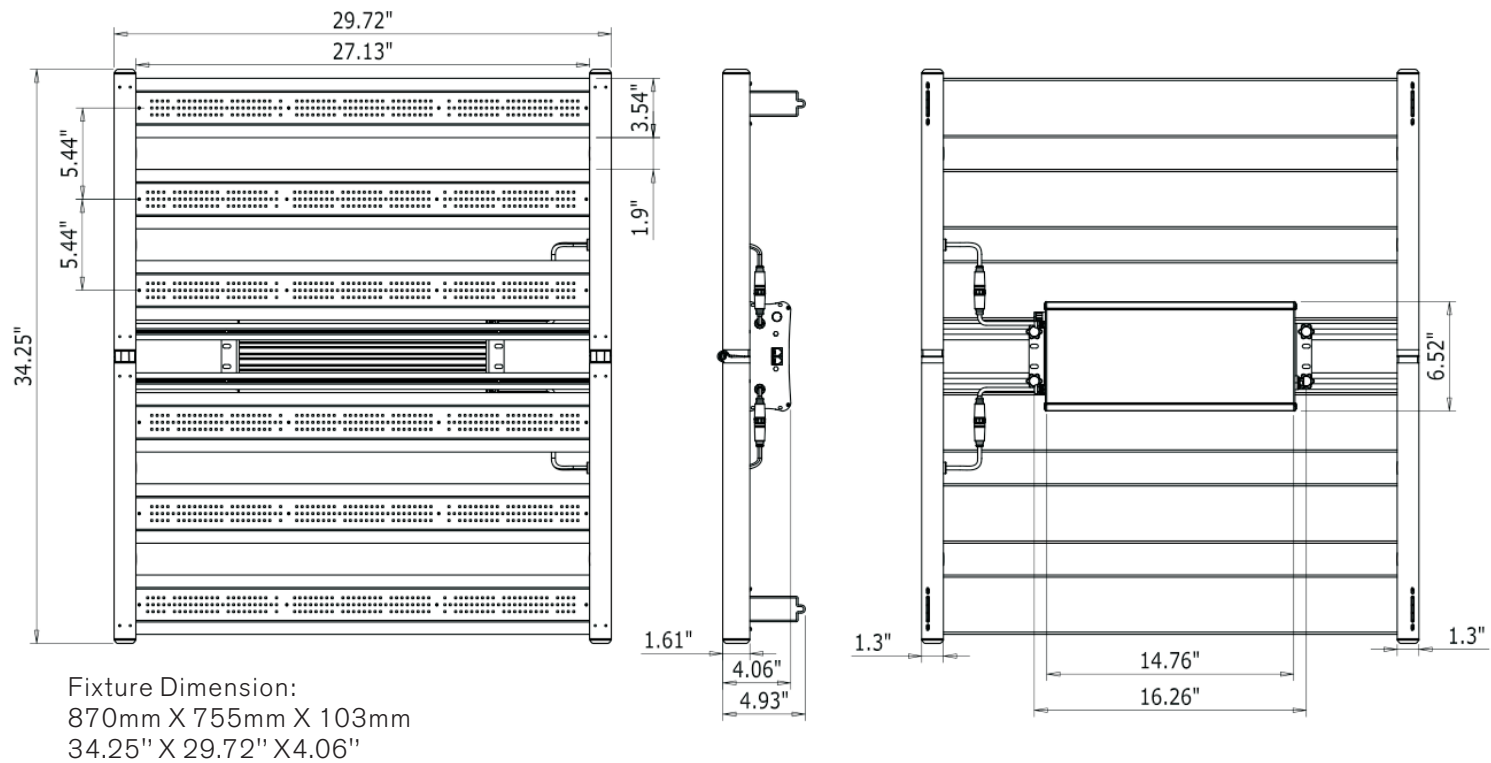

Package

HELENOR SMART-480W Luminaire + Driver Box	
Carton Size	82cm X 66cm X 15cm (32.2" X 25.9" X 5.8")
Weight	24.24 LB (11 KG)
Qty. / Ctn.	1 set

Safety Warnings

- Warning!** The installer is responsible for correct and safe installation.
- Warning!** Do not connect or disconnect the fixture with the driver box while under load.
- Warning!** Mount the system to something that can hold the weight of the LED fixture.
- Warning!** Do not touch the leds to avoid damage.
- Warning!** Switch off the mains power before installation.

1

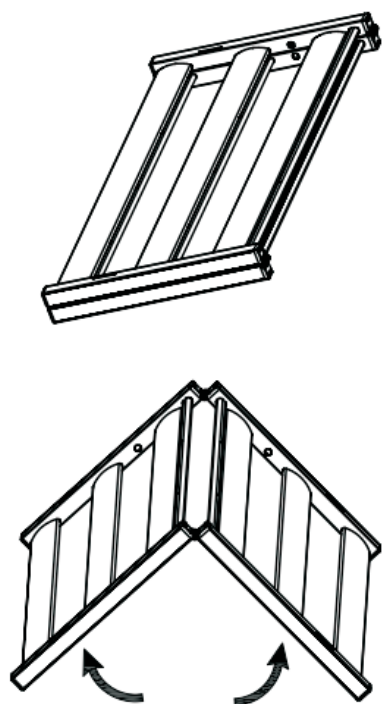

Unfold the LED fixture.

2

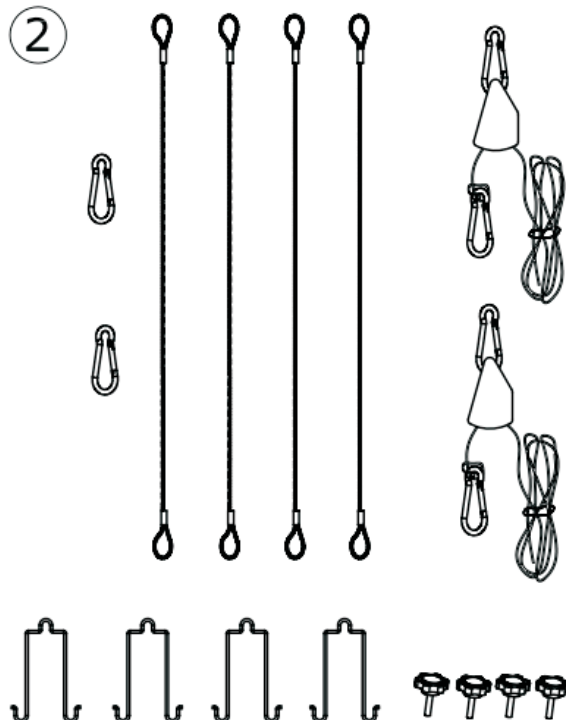

Take out the accessories from bags.

3

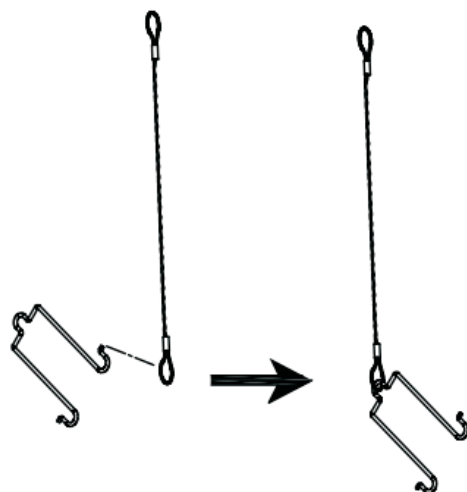

Connect mounting clips with steel ropes.

4

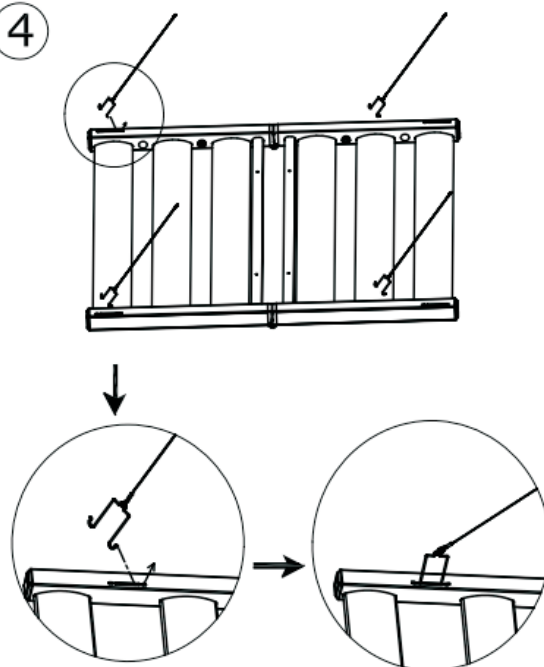

Snap mounting clips into fixture rails.

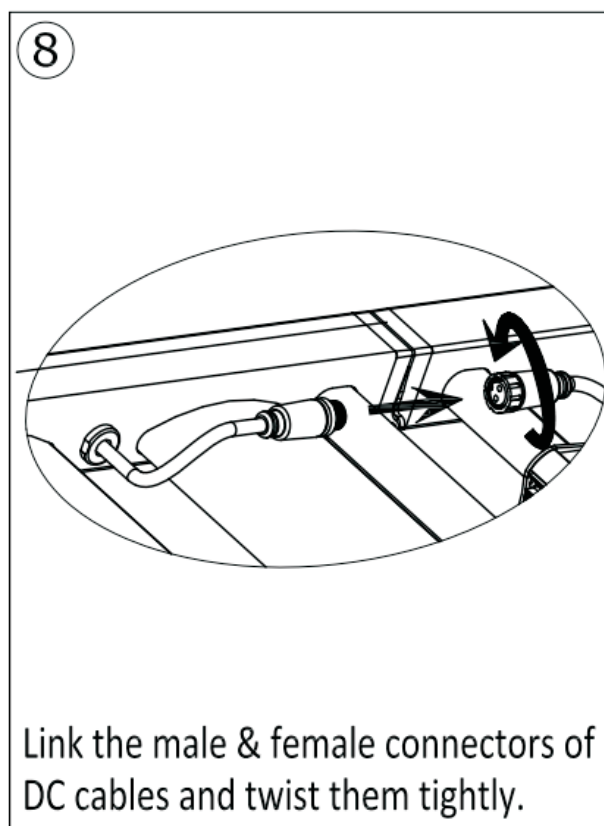
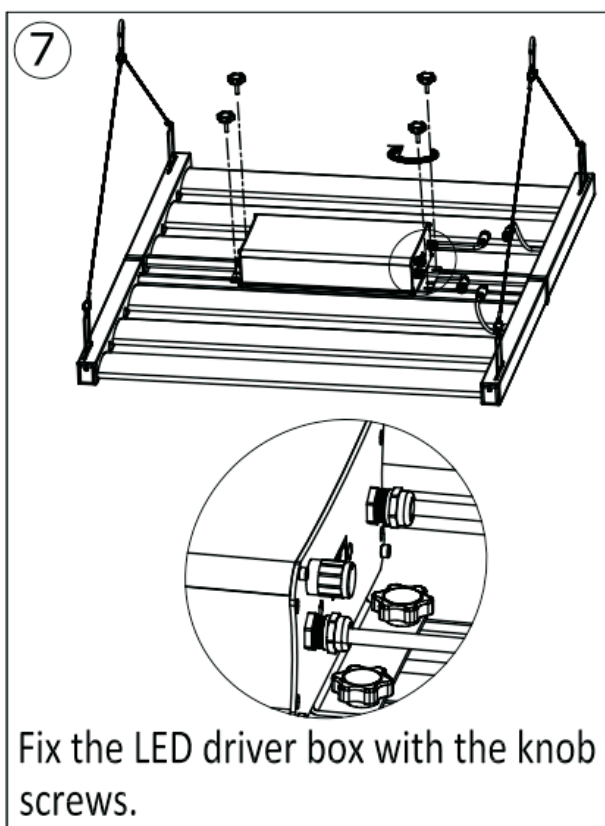
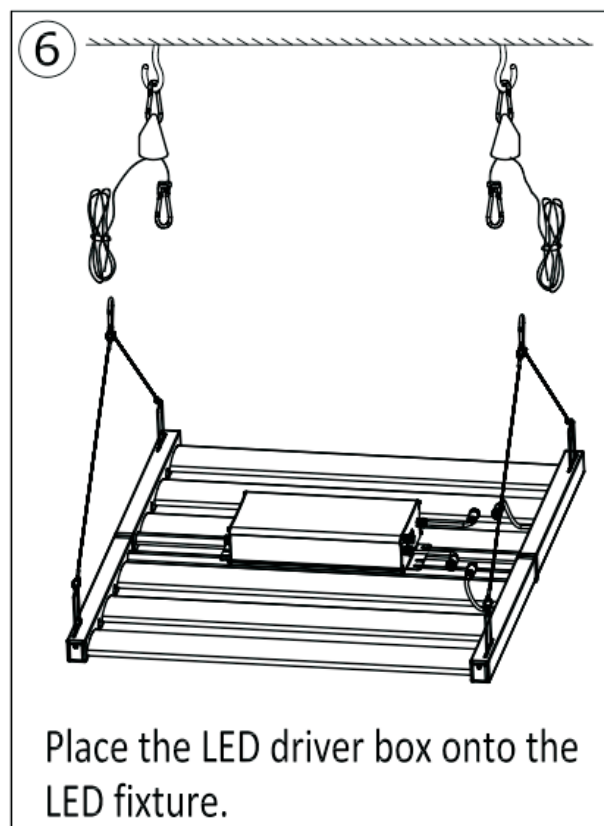
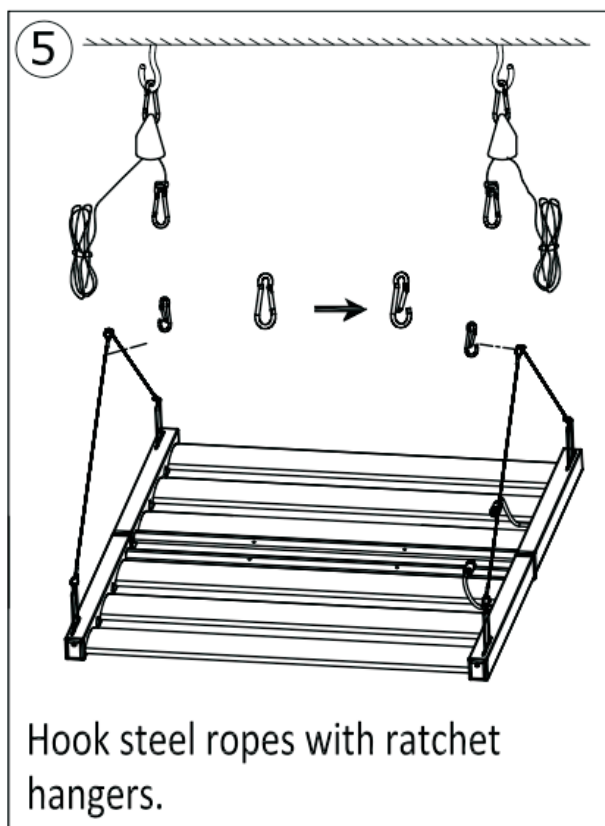

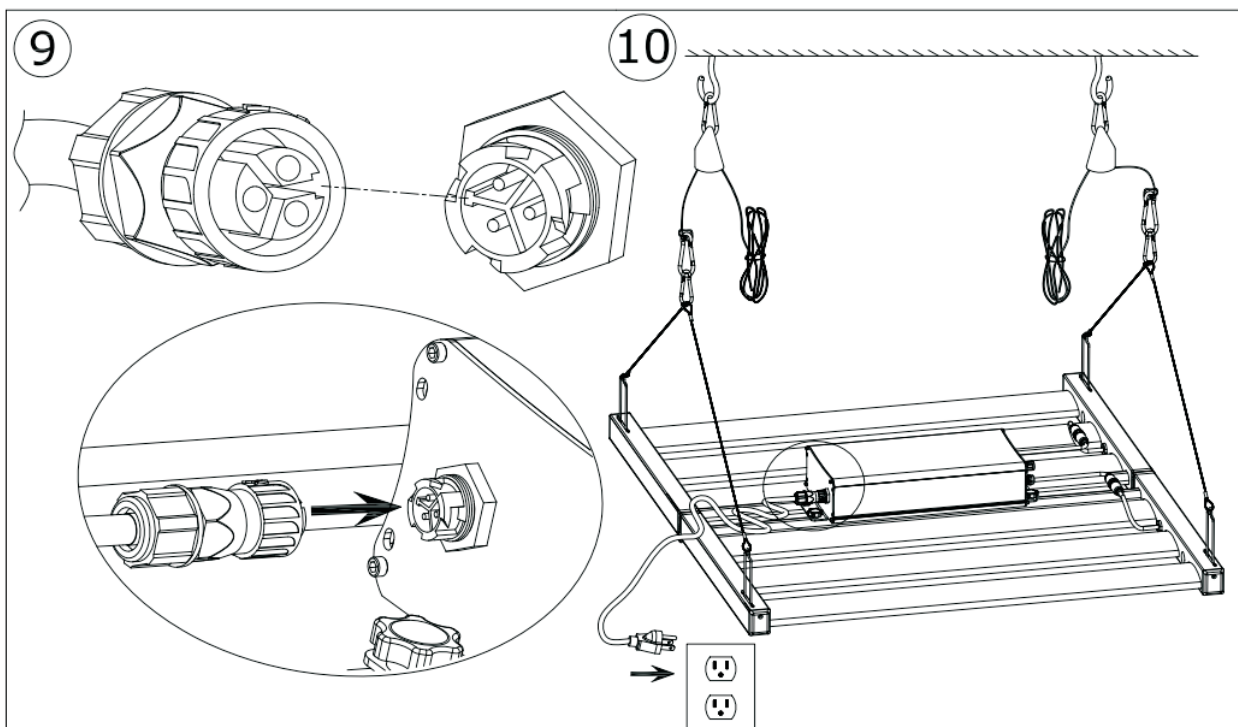

Follow the correct direction to connect the AC power cord with driver box.

Push the AC power plug into wall outlet.